

2BKH V-BELT SHEAVES

For 4L, 5L, A or B Belts
2 Grooves
1.750" Face Width
Cast Iron
Split Taper Style
H Bushing



Part Number	Diameters			Type	Dimensions							Wt. Ea. (Lbs.)
	Out. Dia. (in)	Pitch Dia. "A"	Pitch Dia. "3L"		OAL	L	P	C	X	G	E	
2BK32H	3.350	2.600	3.000	1	2.813	1.250	0.875	1.313	0.875	0.438	0.188	2.1
2BK34H	3.550	2.800	3.200	1	2.813	1.250	0.875	1.313	0.875	0.438	0.188	2.4
2BK36H	3.750	3.000	3.400	1	2.375	1.250	0.438	0.875	0.875	0.438	0.188	2.0
2BK40H	3.950	3.200	3.600	1	2.375	1.250	0.438	0.875	0.875	0.438	0.188	2.4
2BK45H	4.250	3.500	3.900	1	2.375	1.250	0.438	0.875	0.875	0.438	0.188	3.0
2BK47H	4.450	3.700	4.100	2	1.750	1.250	0.438	-	0.875	0.438	0.188	2.8
2BK50H	4.750	4.000	4.400	2	1.750	1.250	0.438	-	0.875	0.438	0.188	3.3
2BK52H	4.950	4.200	4.600	2	1.750	1.250	0.438	-	0.875	0.438	0.188	3.6
2BK55H	5.250	4.500	4.900	2	1.750	1.250	0.438	-	0.875	0.438	0.188	3.9
2BK57H	5.450	4.700	5.100	2	1.750	1.250	0.438	-	0.875	0.438	0.188	4.3
2BK60H	5.750	5.000	5.400	2	1.750	1.250	0.438	-	0.875	0.438	0.188	4.4
2BK62H	5.950	5.200	5.600	2	1.750	1.250	0.438	-	0.875	0.438	0.188	4.5
2BK65H	6.250	5.500	5.900	3	1.750	1.250	0.438	0.250	0.875	0.438	0.188	4.5
2BK67H	6.450	5.700	6.100	3	1.750	1.250	0.438	0.250	0.875	0.438	0.188	5.0
2BK70H	6.750	6.000	6.400	3	1.750	1.250	0.438	0.250	0.875	0.438	0.188	5.1
2BK80H	7.750	7.000	7.400	3	1.750	1.250	0.438	0.250	0.875	0.438	0.188	6.4
2BK90H	8.750	8.000	8.400	3	1.750	1.250	0.438	0.250	0.875	0.438	0.188	7.6
2BK100H	9.750	9.000	9.400	3	1.750	1.250	0.438	0.250	0.875	0.438	0.188	8.4
2BK110H	10.750	10.000	10.400	3	1.750	1.250	0.438	0.250	0.875	0.438	0.188	9.3
2BK120H	11.750	11.000	11.400	3	1.750	1.250	0.438	0.250	0.875	0.438	0.188	11.0
2BK130H	12.750	12.000	12.400	3	1.750	1.250	0.438	0.250	0.875	0.438	0.188	13.1
2BK140H	13.750	13.000	13.400	3	1.750	1.250	0.438	0.250	0.875	0.438	0.188	14.8
2BK160H	15.750	15.000	15.400	3	1.750	1.250	0.438	0.250	0.875	0.438	0.188	17.5
2BK190H	18.750	18.000	18.400	3	1.750	1.250	0.438	0.250	0.875	0.438	0.188	21.5

TYPE 1

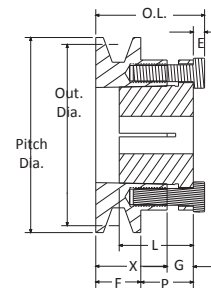

TYPE 2

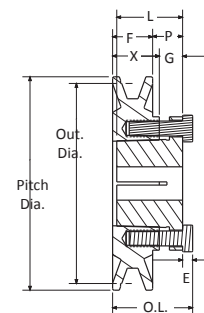

TYPE 3

